



**FACTORY DIRECT**  
— FLOORING —

**IMPORTANT NOTES ABOUT YOUR FLOORING**

**PLEASE READ BEFORE INSTALLING**

**INSTALLATION & MAINTENANCE FOR SOLID WOOD FLOORS**





## ACCLIMATIZATION AND STORAGE

Your new flooring has to be acclimatized before installation, Engineered for a minimum of 72hrs and Solid wood for a minimum of 120hrs. The flooring must remain in its packaging stored horizontal in the room which it is to be installed into. Please Note the room must be dry and have a constant relative humidity between 45 - 60% as this will effect your behaviour of your floor.

## SUBFLOOR

It is of the utmost importance that the subfloor is dry, clean, solid and flat. You can find appropriate electronic moisture meters in DIY stores, The subfloor must be flat and the flatness tolerances must be observed. The installer must always and in particular with renovation work check the current status of the subfloor, if it does not meet the requirements stated here extra work will need to be carried out to level the subfloor out, to determine the flatness of your floor apply these tolerances over 1m length the floor must not be more than 3mm difference and over 2m that rises to 4mm.

## TOOLS

Having the correct tools and equipment and understanding of how to use them safely is key to a successful installation, in conjunction with some standard hand tools Hammer, Hand Saw, Square, tape measure, screw driver you may wish to use power tools such as a chop saw, jigsaw or cordless screwdriver to speed you along, paying attention when cutting with power tools to observe the blade cutting direction and place the plank accordingly to prevent breakout on the finished surface.

## EXPANSION

Depending on the climate conditions your flooring **will** expand or contract, it therefore needs to be kept a suitable distance away from any fixed structures such as walls, supports, door frames, radiator pipes etc, this is called the expansion gap. This gap should be a minimum of 10mm when using solid or engineered floors a gap of 8mm can be allowed on Laminate in smaller areas on each edge of the floor, larger areas the gap will need to be increased. As a guide each linear meter of flooring fitted requires a 2mm gap either side of the floor, e.g. a 6m run will require an expansion gap of 12mm each side of the floor. Larger areas such as angular areas or installations that cover more than one room will require additional clearance, these gaps can be hidden by using expansion profiles or a scotia bead, for areas over 6m x 10m please call for further assistance.

## PLEASE NOTE

- As your floor is a natural product, structure and colours in wood may vary. That is why we recommend mixing floor boards coming from different packages when installing your floor.
- All flooring will **CHIP, DENT** and **SCRATCH** unless care is taken to **PROTECT** it, **FELT PADS** should be used on all moveable furniture. Matting at room entrances will greatly reduce grit and dirt from being transferred onto your flooring
- Liability for the installation remains with the installer following the fitting instructions and guides supplied



It is the responsibility of the installer to ensure that the location for the fitting of this product is suitable prior to it being installed

**Easy Lay Installation with a Pre-Glued Underlay**

Pre-Glued underlay for tongue and groove solid or engineered floors,  
available with a vapour barrier for concrete or stone based subfloors or without for wooden subfloors.



**1** ROLL OUT THE EASYLAY OVER THE POLYTHENE MOISTURE BARRIER IN ROWS NEXT TO ONE ANOTHER (THE



**2** TURN OVER THE EASYLAY SO THAT THE SMOOTH PROTECTIVE LAYER IS ON THE UPPER SIDE

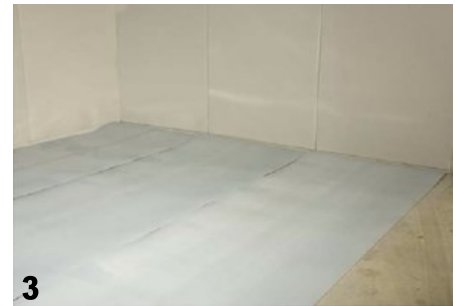

**3** COVER THE ENTIRE FLOOR SURFACE WITH EASYLAY



**4** FOLD BACK THE PROTECTIVE FOIL OF THE ADHESIVE LAYER OVER A WIDTH OF ONE OR TWO BOARDS, THE ADHESIVE LAYER IS NOW EXPOSED



**5** FOLD A PIECE OF FILM TAKEN FROM SOME SPARE UNDERLAY IN TWO, DON'T WORRY KEEP IT SAFE AND THE UNDERLAY CAN BE USED LATER

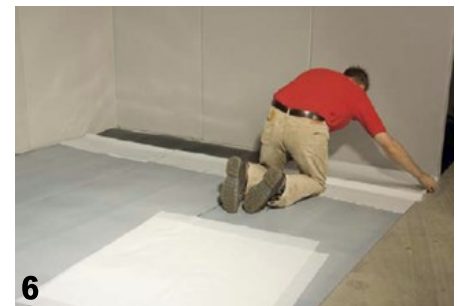

**6** CAREFULLY PLACE THE SPARE FILM ONTO THE EXPOSED ADHESIVE LAYER WITH THE FOLD FACING THE WALL



**7** POSITION THE SPARE FILM AS SHOWN



**8** THE FIRST PARQUET SECTION OR BOARD IS NOW POSITIONED ON THE SPARE FILM



**9** With wedges a minimum expansion of 10mm needs to be allowed, for larger rooms this needs to be increased.



**10** THE SECOND BOARD IS TAPPED INTO THE FIRST TO GIVE A TIGHT FIT, FOLLOWING THIS, THE SPARE FILM BETWEEN THE EASYLAY AND THE BOARDS IS REMOVED. FROM NOW ON WORK IS CARRIED OUT WITH THE ACTUAL PROTECTIVE LAYER OF EASYLAY



**11** FROM HERE ONWARDS, SEVERAL ROWS CAN BE POSITIONED SEAMLESSLY BEFORE THE PROTECTIVE LAYER BETWEEN THE WOOD AND THE EASYLAY IS REMOVED



**12** YOUR FLOOR CAN BE WALKED ON DIRECTLY FOLLOWING THE INSTALLATION

**N.B.** IT IS RECOMMENDED TO ONLY GLUE THE PARQUET, SOLID OR STRIP FLOORING ON THE END JOINTS IN THE TONGUE AND GROOVE USING A RECOMMENDED PVA GLUE

It is the responsibility of the installer to ensure that the location for the fitting of this product is suitable prior to it being installed

## Full Stick Down Installation for Solid and Engineered Floors



1. Once the sub floor has been deemed suitable for this installation, is flat and dust free, your floor can be set up for fitting, in the case of a herringbone and mitered herringbone, the installation needs to be started from the central axis, for straight lay typically the longitudinal side of the flooring should run across to the longitudinal side of the room this has the effect of making the room larger.



2. With a 6mm wood floor adhesive trowel the flooring adhesive is spread in a criss-cross pattern onto the sub floor as seen in the picture its advised to work on small areas at a time. Your wood floor adhesive will yield about 1m<sup>2</sup> of coverage to 1000g of adhesive.



3. Set the plank into the adhesive, pressing it in making sure of a good contact and subsequent planks in a random A symmetric pattern and allowing for an expansion gap at the edge, this type of installation does not require you to glue the tongue and groove.

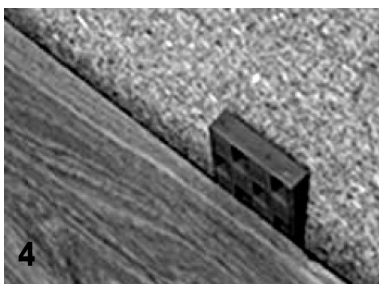

4. The positioning of wedges between the plank and the wall will allow an expansion gap all around the edge of the room, A minimum expansion of 10mm needs to be allowed, for larger rooms this needs to be increased, continue to lay your floor checking regularly for alignment and squaring if required.



5. the last row of planks to be fitted will need to be tailor cut to suit the width left less the expansion gap. As part of preparation if the width of the room is measured and it leaves the final row to be less than 50mm reduce the front row to make it the same as the last.



6. Fitting the final row will require the use of a pull bar or pulling iron this specialized tool makes up part of the solid wood floor / engineered fitting kit along with wedges and a tapping block. The wedges placed around the edge of the floor to maintain the expansion gap can be removed after 24hrs.



It is the responsibility of the installer to ensure that the location for the fitting of this product is suitable prior to it being installed

## Tongue Tite Screw Installation

### Onto a wood based sub-floor for Engineered or Solid Wood Floors With a Tongue & Groove Profile



1. Cut the first row to size, centre and align the planking to the area

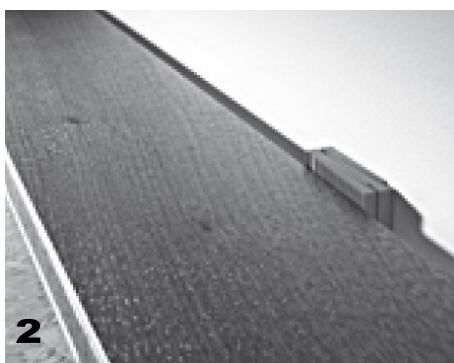

2. An allowance for an expansion gap needs to be maintained by placing wedges at the perimeter edge of the floor. A minimum expansion of 10mm needs to be allowed, for larger rooms this needs to be increased



3. The planks in the first and last rows are fixed from the top with either nail or screw, the fixing is placed around 15mm from the edge of the plank

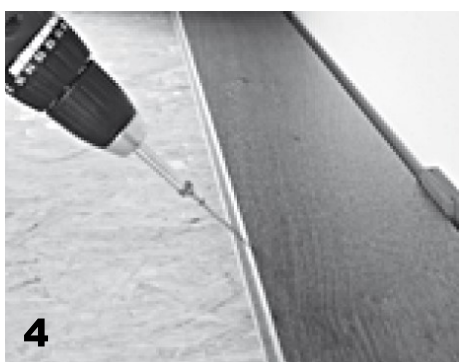

4. The fixing is made into the plank just above the tongue at 45°, for a secure fix we recommend that a screw be fixed every 300mm



5. The row finishes by cutting your plank allowing for the expansion gap the cut off piece will return and start the second row



6. with the tapping block from your solid wood / engineered floor fitting kit Join the planks together by tapping gently with a hammer.



7. A pull bar or pulling iron can be used to help seat the end planks effectively



8. When finishing the last row a piece of off cut can be placed over the board to be cut in and used to scribe the shape of the wall.

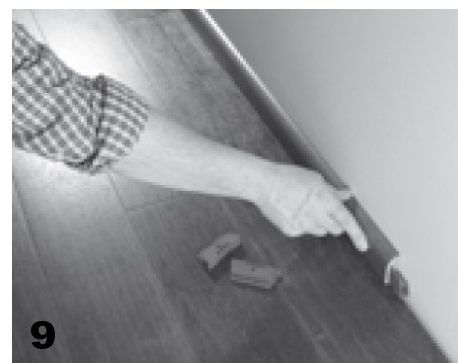

9. The expansion gap can be covered with a solid wood skirting or hardwood scotia.



Caring for your real wood floor surface well both enhance its looks and prolong its life with some simple routines your wooden floor will give you years of pleasure.

### **Lacquered floors**

Keeping your lacquered real wood floor is very easy, for day to day cleaning the use of a fine soft broom or vacuum cleaner with an attachment will keep most loose dirt and grit off the surface if necessary clean with a well rung out damp cloth or mop, always wipe off any spilled liquids as soon as possible, special cleaners and emulsions are available for more intense cleaning of lacquered floors but always follow the instructions and the individual manufactures guide lines. Mats placed at the entrance points to your floor will also help reduce the amount of dirt, grit and dampness form being brought onto the floor, felt floor protectors when attached to chair or table legs or any other easily moved furniture will greatly reduce the chance of damage to your floor. In excessive cases of wear Lacquered floors can be stripped sanded and re finished.

### **Oiled surfaces**

Regular cleaning of your oiled floor will ensure easier maintenance as a whole and increase its resistance to wear, for a day to day routine the use of a fine soft broom or vacuum cleaner with an attachment will keep most loose dirt and grit off the surface if necessary clean with a well rung out damp cloth or mop for maintenance of oiled floors add the recommended amount of cleaning agent for oiled floors this will create a protective film on the surface which will increase the resistance to wear on the floor follow the guide lines in the use of cleaning products giving enough time to allow the floor to dry before using again. Mats placed at the entrance points to your floor will also help reduce the amount of dirt, grit and dampness form being brought onto the floor, felt floor protectors when attached to chair or table legs or any other easily moved furniture will greatly reduce the chance of damage to your floor. Single planks can be re oiled as required it is recommended that in a residential location the complete floor is re oiled once a year commercial locations dependant on use may require more.

Never use a wet mop or large amounts of water during cleaning

Never use abrasive cleaners or scourers on wood floors

Do use drip trays underneath pot plants to protect your wood floor

Do use mats in high traffic areas and at the entrances to your wood floor

Do use Felt Floor Protectors to Chair and Table legs or all easily moved furniture

Do remove any spills as soon as they occur

Minor damages can be repaired with touch in kits to suit the colour of the floor