



**FACTORY DIRECT**  
— FLOORING —

# Safety Flooring Installation & Care Guide



**IMPORTANT NOTES ABOUT YOUR FLOORING. READ BEFORE INSTALLING**

# Care Guide

## Acclimatization and Storage

Your new flooring has to be acclimatized for 24 hours before installation begins. The flooring must remain in its packaging stored Vertically in the room this is to prevent flat areas forming in the roll and causing installation issues care must be taken to secure any rolls stood on end to prevent them falling , which it is to be installed into. Please Note the room must be between 18° and 27°, room conditions should never exceed 50° or fall below 10°.

## Subfloor

It is of the utmost importance that the subfloor is dry, clean, solid and flat. You can find appropriate electronic moisture meters in DIY stores, the subfloor must be flat and the flatness tolerances must be observed. The installer must always and in particular with renovation work check the current status of the subfloor, if it does not meet the requirements stated here extra work will need to be carried out to level the subfloor out, to determine the flatness of your floor apply these tolerances over 3m length the floor must not be more than 3mm difference.

## Underfloor Heating

We can recommend water based underfloor heating systems be used with your safety flooring with a temperature not exceeding 27°C and an average running of 20°C. The heating must be turned off 48hrs prior to installation and once the flooring has been installed turned on with an increase in working temperature of 5°C per day until normal operating temperature has been reached. Water Based heating pipes are to be fitted a minimum of 30mm below the subfloor surface and electric based cables and grids a minimum of 10mm.

## Tools

Having the correct tools and equipment and understanding of how to use them safely is key to a successful installation, Broom and or a vacuum cleaner, tape measure, pencil, ruler, utility knife, 50kg Mini Roller, adhesive towel, grooving and welding tools.

## PLEASE NOTE

All flooring will CHIP, DENT and SCRATCH unless care is taken to PROTECT it, FELT PADS should be used on all moveable furniture. Matting at room entrances will greatly reduce grit and dirt from being transferred onto your flooring.

Liability for the installation remains with the installer following the fitting instructions and guides supplied and ensuring that the product and area are both suitable to be installed.

Conservatories and rooms with excessive light should be avoided unless protection screens are used, this can be glass protection or blinds.

Always inspect materials for faults or damage as no claims on surface defects can be accepted after installation.



# Safety Flooring Installation Guide

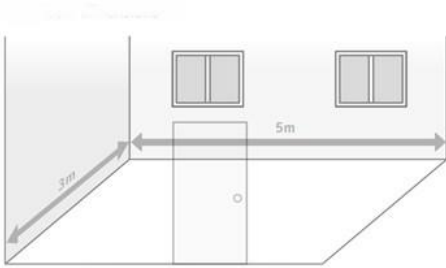

When considering the direction of lay, take in account the direction of incoming light, if the room is a square or rectangular shape, position of the joints and economical use of material they all have a bearing on direction of lay.

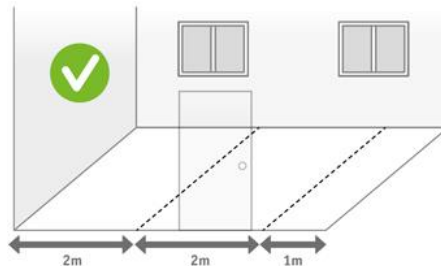

This example allows the joint in the floor to fall away from the door, it has been laid with the incoming light source, had the room been long and thin it may have been better to lay with the length of the room.

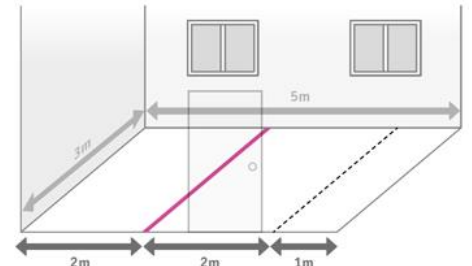

Mark a reference line, this will allow you to lay the sheet of safety flooring to this guide.

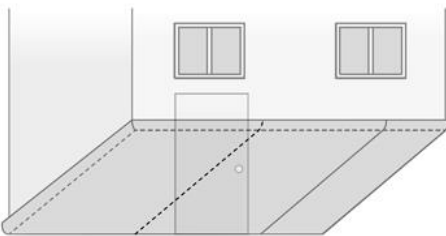

The safety flooring can be roughly cut to the size of the room, leave approximately 25mm of spare material in order to cut into the wall. The floor can be allowed to relax this will assist with a smoother installation.

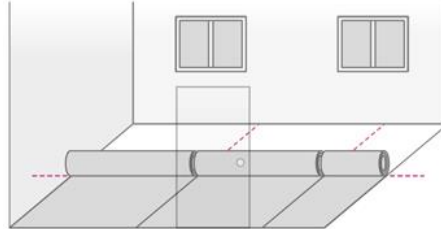

In order for the adhesive to be spread the rolls will need to be rolled or folded back to a suitable point in this case at the halfway in the room.

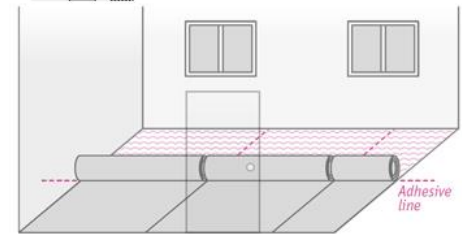

Selection of the correct adhesive is essential and local conditions will need to be factored in to select a suitable adhesive. Using a notched trowel the adhesive can be applied to the subfloor.

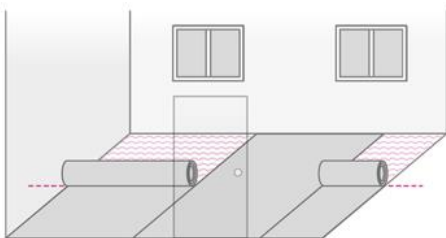

When laying the first sheet observe the marked reference line as the installation will be built up from this first sheet.

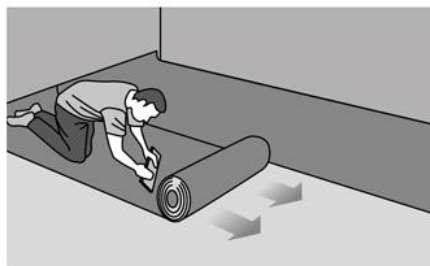

When laying a sheet, it's crucial that no air be caught under the flooring as this will cause blisters later, using a cork press as you gradually roll out the flooring into the adhesive will help prevent this.

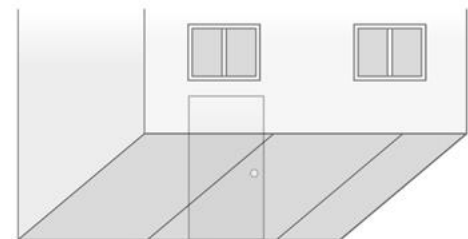

Once all the sheets have been laid into the adhesive preparation can be made to lay the other halves of each sheet.



# Safety Flooring Installation Guide

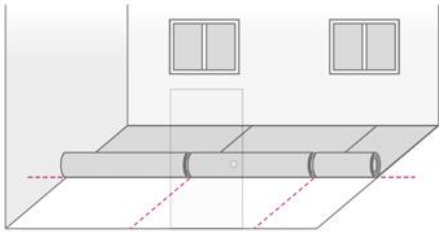

The same procedure can be followed as the other half of the flooring and it can be rolled or folded back.

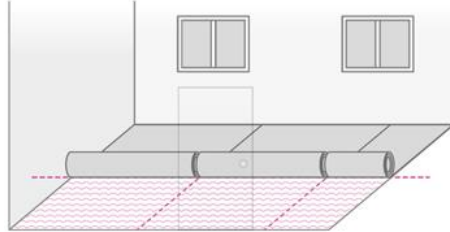

The adhesive can be spread making sure there is no gap between the first side and this side.

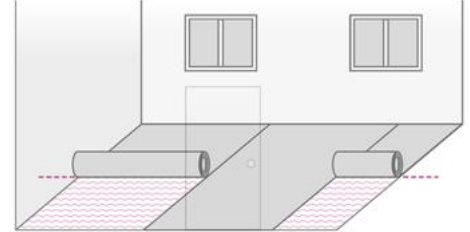

Begin to lay this side of the room following and using the same techniques as the first side.

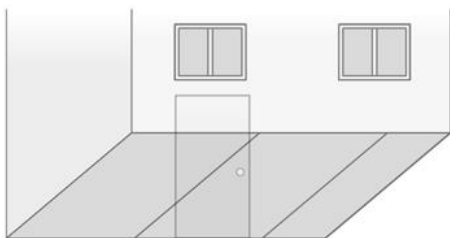

Once the flooring has been adhered the excess can be trimmed off with a knife.

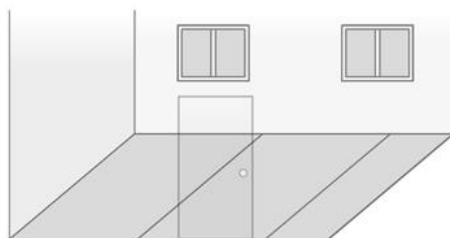

It's recommended to roll the floor to make the best bond possible, a 50kg roller is ideal for this task.

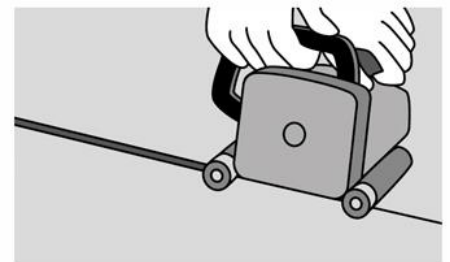

After 24hrs any jointing can be started, Joints are created enabling the two pieces of flooring to be welded together forming a seamless surface.

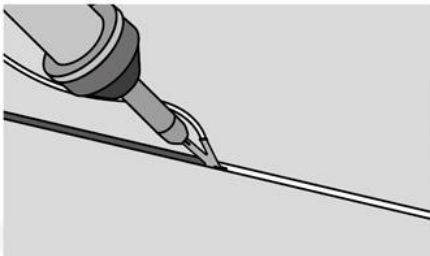

Using specialist equipment, the two pieces are joined or welded together in this case the weld rod is heated and fed into the created joint with a hot air welder.

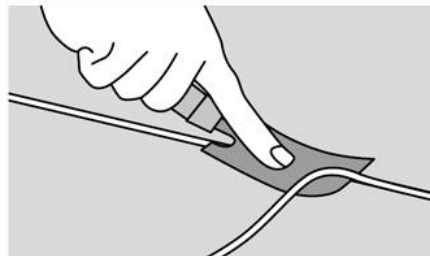

The weld is then trimmed, and excess weld material is removed to give the finished floor.



**FACTORY DIRECT**  
— FLOORING —

# Aftercare

## How to Care for Your Floor

1. Remove all loose dirt and debris from the flooring by using a vacuum cleaner, broom or a dust pan and brush, electro static wipes, if you are using a vacuum cleaner please refer to the manufacturers guidelines and make sure that it will be suitable for cleaning aqua plank flooring.

2. We recommend that only PH Neutral cleaners and disinfectants are used during the cleaning of your new floor, try to remove spills as soon as they arrive on the floor and rinse down with warm clean water, please be aware no flooring product will be impervious to every chemical or solvent and to avoid rubber and petroleum based products such as tyres, casters, floors mats and asphalt sealers which may contain chemicals that could react and permanently stain your floor.

3. We recommend fitting a suitable non-rubber backed matting as this can prevent up to 80% of tracked in dirt debris.

4. Avoid swamping the floor area with detergent and rinse water, take care to remove all liquids off the surface as re-deposited rinse water with dirt and detergent can settle on the surface and give a hazy appearance.

5. Safety floors cover a great many applications and can have specific regimes to keep them clean and maintained always refer to the manufacturers guidelines before undertaking any cleaning.

### HELPFUL TIPS

Avoid dragging or sliding heavy items of furniture, carousels and point of sale across the floor.

Spending a small amount of time looking after your new vinyl floor will ensure that it continues to look at its best and provide you with many years of carefree use without the need of costly maintenance and repairs.

Never use abrasive cleaners or scourers

Never use waxes or floor polishes during cleaning

DO USE MOP AND WATER FOR CLEANING

DO USE DRIP TRAYS UNDERNEATH POT PLANTS

DO USE PH NEUTRAL CLEANERS

DO REMOVE ANY SPILLS OR EXCESSIVE LIQUIDS AS SOON AS THEY OCCUR



**FACTORY DIRECT**  
— F L O O R I N G —