

Installation at a glance

Engineered wood flooring can be installed in two different ways: by all-over adhesion or in a „floating-floor-type“ installation. An advantage of all-over adhered engineered wood floors is that they are comparatively low-noise, because vibrations and hollow sounds are largely eliminated. Thanks to the convenient *AUTOMATIC-CLICK* system, the installation of engineered wood boards as a „floating floor“ is particularly fast and easy to do even without any previous knowledge and has become the most popular method of installation.* Here is how it works:



1. Unroll the underlay and put it on the prepared subfloor.



2. Center and align the planking area and cut the first row to size.



3. Use the spacer wedges to guarantee the wall spacing of at least 10 to 15mm towards all walls and structural parts within the room.



4. The last board of the first row is cut to the right size - don't forget to include the wall spacing. The cut-off piece is used as the starting piece for the second row.



5. Start your next row from the left hand side like before. Simply click together the planks' longitudinal sides. The use of glue is not required here.



6. Join the short end sides together using a hammer and the hammering protection device. During this process the longitudinal and short end joints will interlock automatically. Continue to install the rest of the room in this manner.



7. Use a cut-off piece to transfer the profile of the wall to the last row of planks.



8. Cover the gaps all around the flooring area with matching skirtings from Parador's wide selection.



9. You are done!



10. *Industrial Design Flooring requires full-surface glue down installation.

More detailed information on all installation topics starts at page 14.

Special detailed installation instructions for Engineered Wood Flooring Trendtime 3 Herringbone starting at page 17. Prior to installation please refer to and obey the rules of installation that are stated on the following pages. Paying attention to these rules and advice is a prerequisite to the success of your installation and also guarantees that your engineered wood flooring will be a long-term asset.

Installation rules

These installation rules and the step-by-step installation process that is shown here are universal. The package inserts however, may contain further, more specific or even deviating instructions or rules for a particular product that are mandatory and ought to be followed.

1. Inspection for material defects

Inspect your engineered wood planks thoroughly for their quality prior to and during installation. Flooring planks with visible defects or damages must not be installed. The installation must take place under daylight conditions or with excellent artificial light to make sure that any possible damages or faulty planks can definitely be detected.

2. Acclimatising prior to installation

The engineered wood planks must acclimatise for a period of at least 48 hours at temperatures above 17°C and humidity between 50 - 65 % in that room in which they are to be laid. That means the closed packages have to adjust to the climatic conditions in the room. If the climatic conditions in the storage location and the installation room are considerably different, the acclimatisation period should be longer. If the climate differences are very small the acclimatisation time can be shorter.

Please store the packages flat on a base without opening them. Paying attention to these guidelines is especially important for new buildings, because humidity levels tend to be particularly high here.

3. No installation in areas subject to splashing water

No installation in permanently moist rooms / wet zones

Engineered wood planks must not be installed in areas where splashing shower water may get onto the floor. Standing water will permeate into the wood and can lead to permanent damages. Engineered wood planks should not be installed in permanently moist rooms or wet surroundings (saunas, small bathrooms etc.) because the danger of penetration with moisture can never be ruled out completely.

If engineered wood flooring is supposed to be installed in a bathroom, it is important to make sure that it is not installed in areas subject to splashing water (i.e. shower, bathtub, lavatory or sink) and that the relative humidity in the room stays within the normal range between 50 and 65% continually.

Any formation of puddles and moisture penetration must be avoided all around the corners of the room, for the joints as well as for the whole flooring area.

4. Condition of the subfloor

Any existing subfloor must be even (max. tolerance 3 mm per 1 m in length), dry and sufficiently stable. Larger depressions should be evened out using standard commercial fillers. The surface of the subfloor should be free of cracks and without any breaks or tears. Loose subfloors or insufficiently stable subfloors (PVC-/ textile flooring) need to be removed. Mineral subfloors/ screed need to be sufficiently dry. Please also refer to the information in the special chapter on Subfloors.

Installation rules

5. Moisture barrier with mineral subfloors

Generally, when installing on any dry, mineral subfloor a 0.2mm thick Polyethylene foil or alternatively Duo-Protect should always be used as a moisture barrier to prevent any residual moisture getting through to the backside of your engineered wood flooring. The purpose of the Polyethylene-foil is that of a moisture barrier only and the joints of the foil need to overlap approx. 30cm and need to be glued together. In no way does the PE-foil act as waterproofing for the building! See also the chapter on Underlays.

6. Keeping expansion joints / wall spacings

As stated before, depending on the climatic conditions the natural material wood will shrink or swell. That is why an installed flooring of engineered wood planks requires sufficient spaces, called expansion gaps, towards all fixed constructional parts, i.e. walls, sustainer, heating pipes and the like. Furthermore, expansion gaps are required if the installation area exceeds certain defined values in length and width (see installation rule 7). One of the most common installation mistakes is actually insufficient wall spacing. Often, this will only become evident during the summer months when higher temperatures and humidity levels lead to a swelling of the wood flooring.

The expansion gap/wall spacing should be at least 10-15mm on each side; with large areas it should be proportionately more. For engineered wood planks the rule-of-thumb is: Every meter of installed flooring requires at least 2mm of expansion space on both sides of the room. (Example: Room width 5m = min. 10mm expansion gap on each side).

Even if the installed material abuts only on a single point in the room the "floating material" may start to warp and press on. Popular areas where this is repeatedly happening are architraves, transition areas to stairs, heating pipes as well as end profiles.

Heavy pieces like for example kitchen islands and closets (where movements of the flooring are possible in one direction only) require the expansion space on one side to be doubled. For heavy pieces and fitted furniture (e.g. fitted kitchen, built-in closets or aquariums) we recommend having them assembled prior to installation of the flooring. The flooring boards however should be laid to reach just under the base allowing easy dismantling of the flooring at any time. All along the walls the expansion gaps are covered with skirtings, in other places special flooring profiles are used. With metal architraves you can also use Acrylic sealants. All of the above is part of and can be found with the Parador range of accessories.

7. Layout of expansion gaps

Due to the fact that the engineered wood flooring will shrink and expand depending upon the climate conditions – as described earlier – the following situations do require additional expansion joints /spaces:

- With larger areas (exceeding 8 x 12m)
- With angular areas
- With installations that cover more than one room

Conceal expansion gaps with the suitable adapting or other transition profiles.

Note: Liability for missing expansion gaps or joints is always with the installer.

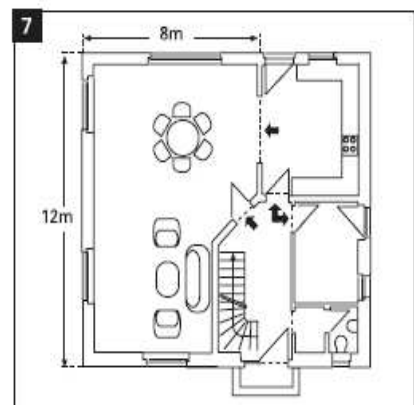
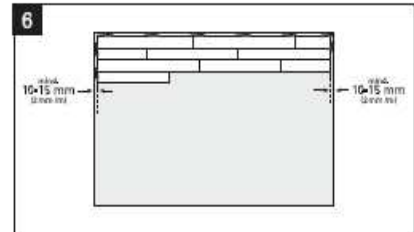

Installation rules

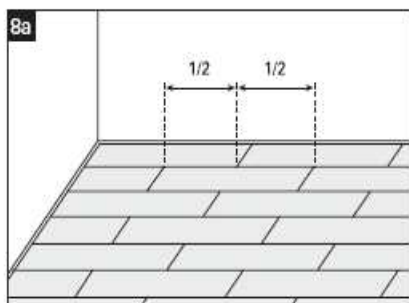

8. Installation patterns and staggering of the joints

Engineered wood flooring can be installed either in a symmetric or in a random, asymmetric pattern. In either case it is imperative that between rows the short-end joints are staggered at least 40 cm; for Trendtime 2 a minimum of 15 cm.

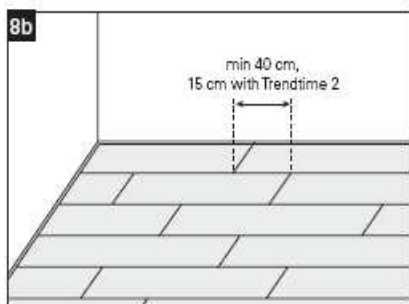

9. Installation direction / incidence of light

For optical reasons the longitudinal sides of the planks should be installed so that they run parallel to the incidence of light. That means, the longitudinal side runs in the same direction as the light. When several windows are present, please make your decision based upon the largest one of them. With extreme floor plans the decision for a certain installation direction can also be based upon the specific room layout. (See installation rule 10)

10. Installation direction / floor plan

Again, for optical reasons the longitudinal sides of the flooring should run across to the longitudinal side of the room. That will make the room look larger and also give it a slightly more "square" appearance so it won't look quite as narrow and tube-like.

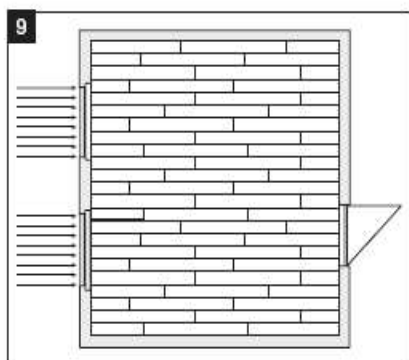

11. Installation from several packages

Please note that engineered wood is a natural product whose unique character comes out through varying colours and structures. These signs of nature can be more or less prominent. Therefore, during installation it is important to make sure that flooring boards from various different packages are being mixed in order to achieve a well-balanced and harmonious overall appearance.

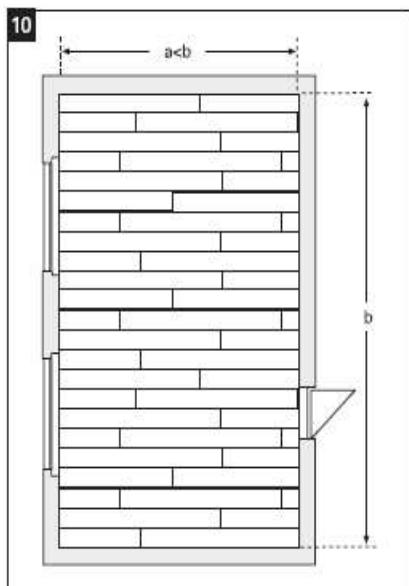

Methods of installation

1. Floating floor installation

Installations where the engineered wood planks are installed without a permanent connection to the subfloor, i.e. the individual flooring boards are connected only with each other, are called „floating floor installations“.

The flooring can move freely („float“) on the underlay/ subfloor. Thanks to the convenient Click-technique installing Parador Engineered Wood Flooring is particularly fast and easy to do even without any previous knowledge and therefore this has become the most popular method of installation.

(Industrial Design Flooring requires full surface glue down installation.)

2. All-over adhesion

An alternative method of installation is „all-over adhesion“. With this method a special adhesive is used to glue the entire flooring area onto the subfloor. The installation with glue is permanent, which means that disassembly/ removal is fairly complicated and time-consuming. The advantage that is offered by this installation method however is that of substantially reduced sound levels, which means that adhered floors are markedly quieter. Thanks to the *AUTOMATIC-CLICK* connection installing the flooring planks on a layer of adhesive is fairly straightforward. Unlike other Click-systems the flooring planks here do not require to be moved within the adhesive layer. This fact guarantees that installation is indeed mess-free, faster and easier than with conventional engineered wood floorings. Please also note the enclosed checklist on All-over adhesion.

3. Installation on subfloor heating

Parador Engineered Wood Flooring is suitable for both „floating floor“ and „all-over adhesion“ installations on hot-water-type radiant heated substrates. The floorings' good heat transfer resistance is the basis for efficiently operating radiant heat systems. Always use Duo-Protect as an underlay for „floating floor“ installations on subfloor heating. Note: When it comes to temperature fluctuations Beech and Maple are sensitive wood types, therefore the appearance of shrinkage signs like open joints etc. cannot be completely ruled out with these.

For installations on electric subfloor heating systems please contact the Parador Applications Technology. Please also read and follow our enclosed checklist on Subfloor heating.

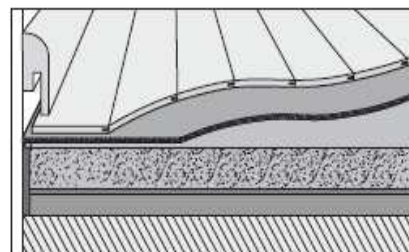

Engineered Wood Flooring on Duo-Protect / Mineral screed

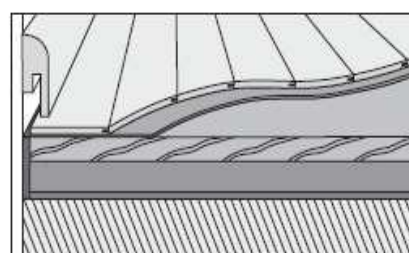

Engineered Wood Flooring on Uno-Protect / Hardwood planks

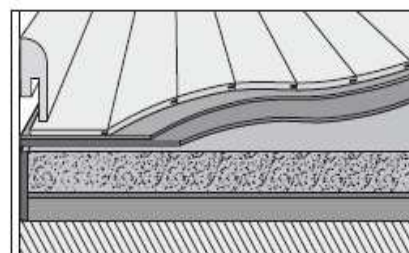

Engineered Wood Flooring on Uno-Protect / PVC / Mineral screed

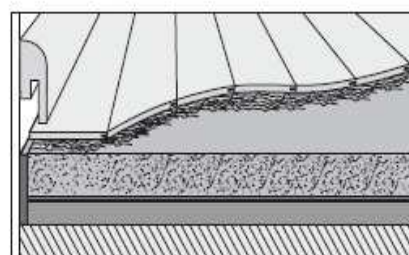

Engineered Wood Flooring, all-over adhesion

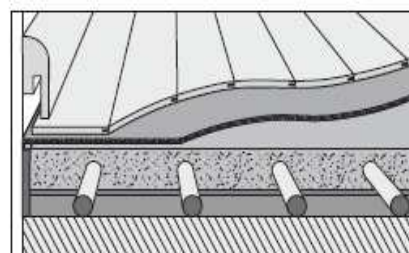

Engineered Wood Flooring on Duo-Protect / Hot water-type subfloor heating

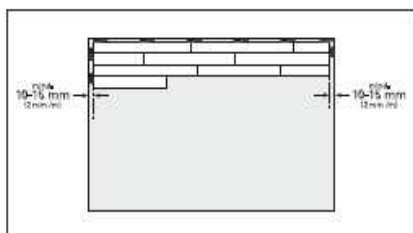

Installation of Engineered Wood Flooring

AUTOMATIC-CLICK system

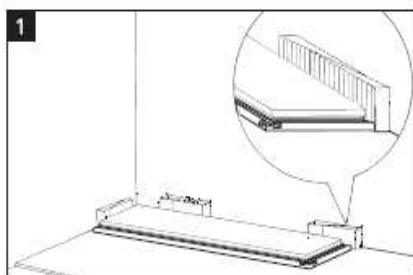

Preparations

Now that you are aware of the most basic regulations and requirements and after the underlay has been installed, let us come to the installation of the flooring planks: In order to achieve a similar appearance of the first and last rows, measure the width of the room transversely to the installation direction and center the width of the flooring planks. Mix the contents of several packages together throughout the installation process to achieve a natural, even look of the flooring area overall. The last flooring plank of each row is cut to size and the sawn-off piece – as long as it is not shorter than 20cm – is used to start the next row. Between rows the cross joints should be staggered by at least 40 cm (min. 15 cm with Trendtime 2) forming a „random connection“. Please inspect all planks prior to installation and use only impeccable planks for your flooring.

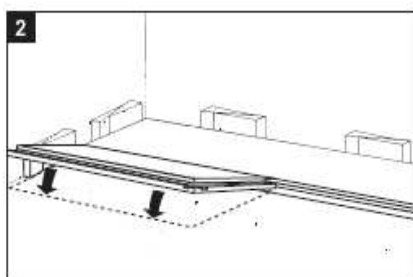

Installation Sequence

Fig. 1: If you don't have to narrow the width of your first row of planks anyway, begin by sawing off the longitudinal tongues of the entire first row of planks. Start laying the first row in the left hand corner of the room with the sawn longitudinal side facing the wall. Use the Parador spacer wedges to ensure the required 10-15 mm expansion gap to the wall. If the wall is not straight see Fig.13. Lay out the first row in a straight line and let the short ends interlock, see fig. 7.

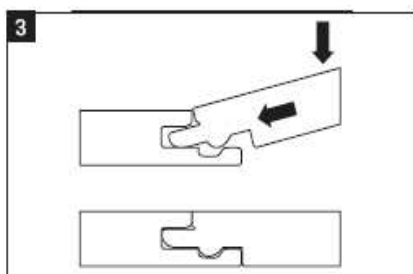

Fig. 2 + 3: Begin the second row on the left side by clicking the longitudinal tongue of the first board into the groove of the first row. To do so, insert the tongue into the groove at an angle of approx. 25° and lower the board. As it is lowered the board snaps into place tightly giving you a press fit.

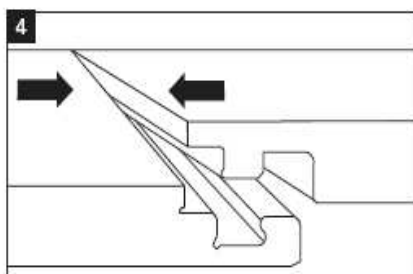
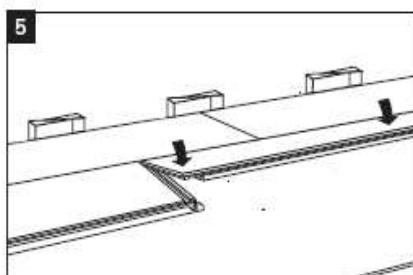

Fig. 4: The next board – and all the others that follow – is inserted lengthwise as described above and before lowering the short end side is positioned flush with the previous board. The solid upper wear layers need to be touching each other!



Installation of Engineered Wood Flooring

AUTOMATIC-CLICK system

Fig. 5 + 6 + 7: The longitudinal joint of the plank is then locked by simply pressing the two boards together and pushing downwards (fig. 3). Before locking the short-end joint, always make sure that the longitudinal joint is locked completely along the entire length of the board. The short-end joint is then locked using a hammer and the hammering protection. (Always make sure that the short-end sides are positioned very closely together as locking is not possible otherwise, see fig. 4). Install all further flooring planks likewise.

Fig. 8: To disassemble, lift off the entire row of boards and pull them out of the previous row diagonally, then pull the end joints apart. To do so it is recommended to use a piece of residual board between the rows of boards and knock the boards apart with a hammer and hammering block. After just a few hits with the hammering block, the connection can be pulled further apart by hand. In this way, the locking mechanism remains intact and the boards can be reused. Important: avoid twisting the boards as this can damage the locking mechanism.

Fig. 9: Measure the end piece with a try square (lay the board down with the groove side facing the previous row) and cut to length. Don't forget the expansion space to the wall! If you are using a jig saw, have the top surface of the board face downwards, if you are using a table saw, let it face upwards.

Fig. 10: Use a piece of residual board to help fit the last row. Remember to keep an expansion space of 10-15mm to the wall.

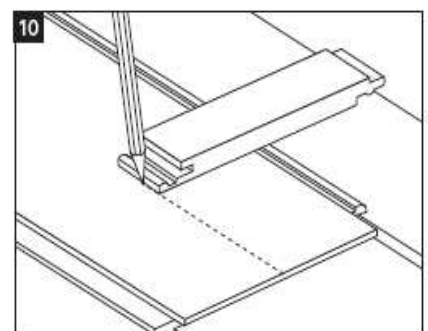
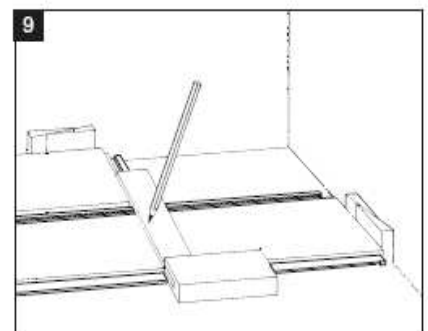
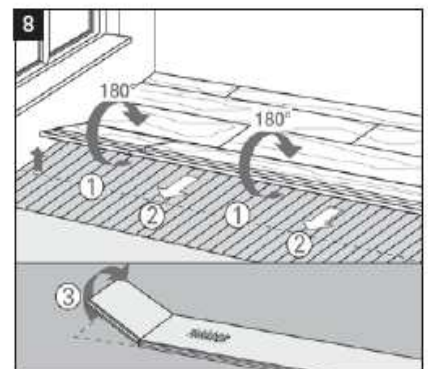
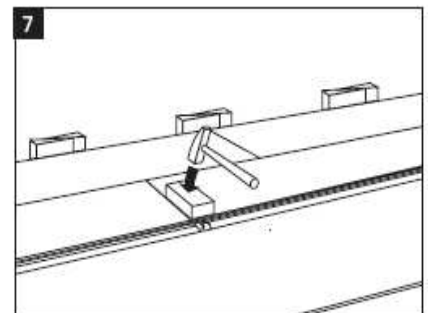
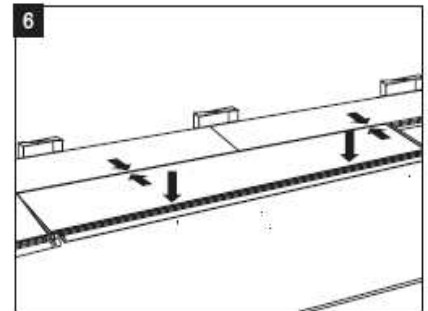

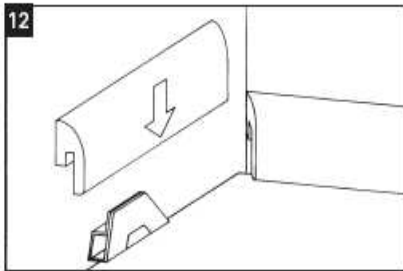

Installation of Engineered Wood Flooring

AUTOMATIC-CLICK system

Fig. 12: The floor is ready for use as soon as the installation is complete. Remove the spacer wedges and attach the Parador skirtings with patented Clip-technique.

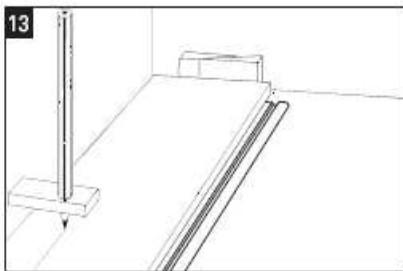

Fig. 13: If the wall is not straight: align the first row in a straight line and follow the course of the wall. Saw the boards off accordingly.

Fig. 14: How to shorten a door frame: place a piece of residual board (on the suitable subfloor/underlay) against the frame and saw the frame off along the board.

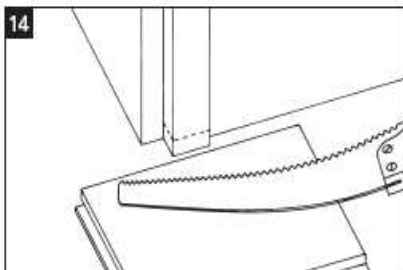
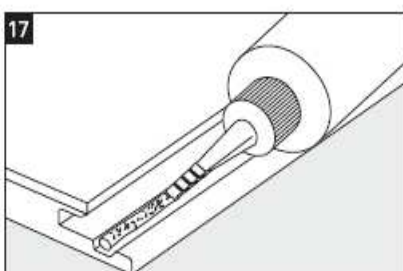
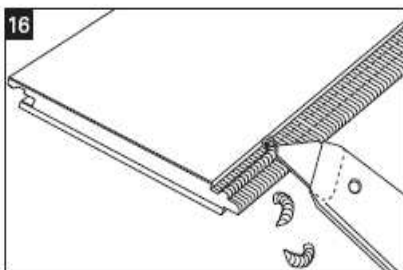
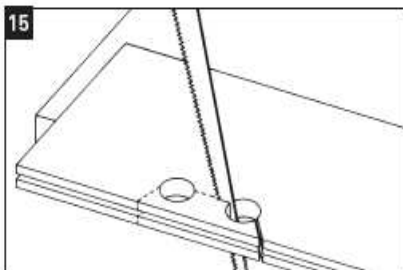

Fig. 15: How to fit your floor around heating pipes: the diameter of the hole in the board should be 20 mm larger than the pipe itself. Mark the spot, drill the holes and saw off at an angle of 45° as shown in the illustration. Glue in the sawn off piece. Don't forget the expansion gap here either.

Fig. 16: Installation in inaccessible areas: whenever the boards cannot be swiveled in and clicked together, it is recommended to remove the catch-mechanism on the backside of the tongue and glue the boards together. Apply the glue onto the lower part of the groove and join the boards together horizontally (conventional tongue-groove principle).

Fig. 17: Glue application. Flooring planks with *AUTOMATIC-CLICK* system may additionally be glued together. To do so, apply the glue onto the lower part of the groove all along the longitudinal sides of the flooring board.



HOW TO CARE FOR YOUR REAL WOOD FLOOR SURFACE

Caring for your real wood floor surface will both enhance its looks and prolong its life with some simple routines your wooden floor will give you years of pleasure.

Lacquered floors

Keeping your lacquered real wood floor is very easy for day to day cleaning the use of a fine soft broom or vacuum cleaner with an attachment will keep most loose dirt and grit off the surface if necessary clean with a well rung out damp cloth or mop, always wipe off any spilled liquids as soon as possible special cleaners and emulsions are available for more intense cleaning of lacquered floors but always follow the instructions and the individual manufacturer's guide lines. Mats placed at the entrance points to your floor will also help reduce the amount of dirt, grit and dampness from being brought onto the floor. In excessive cases of wear Lacquered floors can be stripped sanded and re finished.

Oiled surfaces

Regular cleaning of your oiled floor will ensure easier maintenance as a whole and increase its resistance to wear, for a day to day routine the use of a fine soft broom or vacuum cleaner with an attachment will keep most loose dirt and grit off the surface if necessary clean with a well rung out damp cloth or mop for maintenance of oiled floors add the recommended amount of cleaning agent for oiled floors this will create a protective film on the surface which will increase the resistance to wear on the floor follow the guide lines in the use of cleaning products giving enough time to allow the floor to dry before using again. Mats placed at the entrance points to your floor will also help reduce the amount of dirt, grit and dampness from being brought onto the floor. Single planks can be re oiled as required it is recommended that in a residential location the complete floor is re oiled once a year commercial locations dependant on use may require more.

Never use a wet mop or large amounts of water during cleaning

Never use abrasive cleaners or scourers on wood floors

Do use drip trays underneath pot plants to protect your wood floor

Do use mats in high traffic areas and at the entrances to your wood floor

Do remove any spills as soon as they occur

Minor damages can be repaired with touch in kits to suit the colour of the floor